

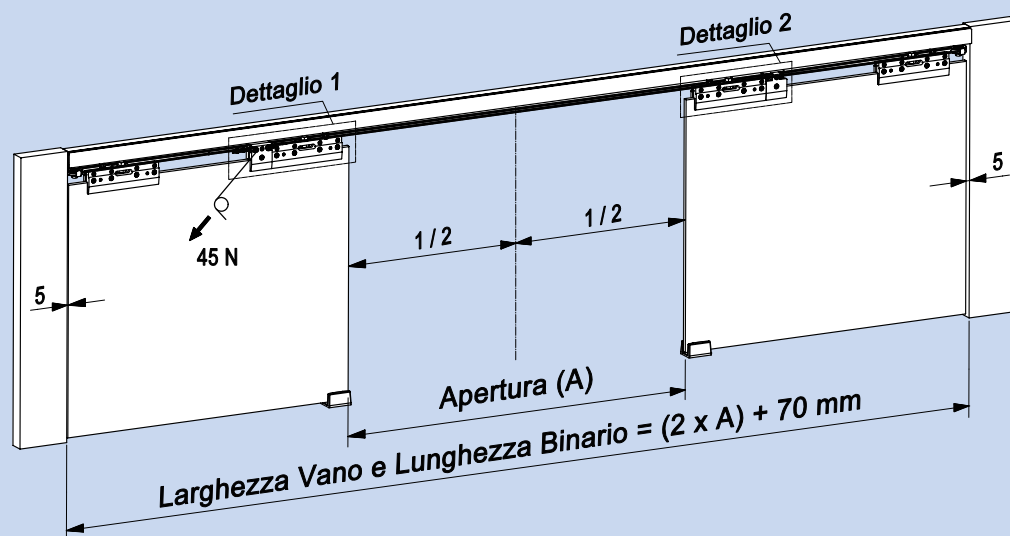

CARATTERISTICHE

1. Non si deve forare il vetro
2. Dimensioni ridotte
3. Sistema particolare di copertura delle pinze
4. Grani e viti inox

ISTRUZIONI PER IL MONTAGGIO



Kit APERTURA
SIMULTANEA
ANTE VETRO

CODICE
10111003

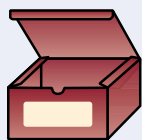

- 2 gruppi portacuscinetto
- 2 pinze
- 10 mt cordino sintetico

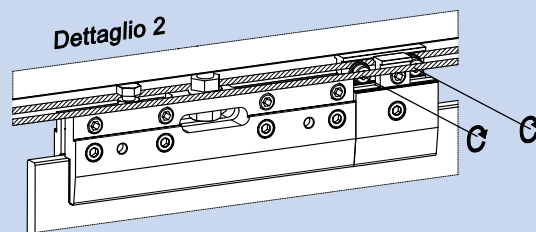
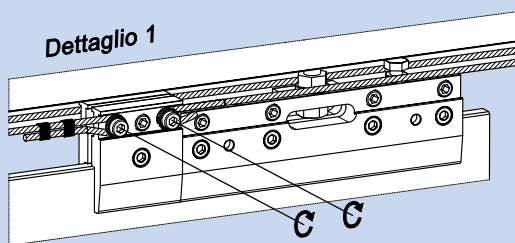

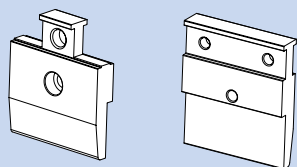

Pinza laterale TIPO A

CODICE 1012206

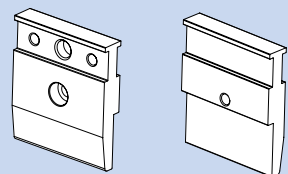

Pinza laterale TIPO B

CODICE 1012207



Cordino sintetico

CODICE 1012209

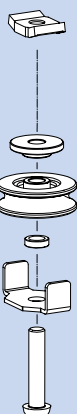

Gruppo portacuscinetto

CODICE 1012210

